

REMOTE VIEWING SESSION DATA

 * Remote Viewer : PS 003 *
 * Interviewer : FA 051 *
 * Observer(s) : _____ *
 * _____ *
 * _____ *
 * Date : 08/02/85 *
 * Starting time : 0733 hours, local *
 * Site # : 718 *
 * Acquisition by: CRV ERV PRV ARV BRV Other _____ *
 * Working mode : GT HEM Other _____ *
 * Feedback class: A B C *
 * _____ *

951601
 975930

 * Ending time : 1139 hours, local *
 * Notes : PI - NO AV Black+White cows *
 * Highest stage : 5 *
 * Evaluation : + 4 *
 * _____ *

 * Actual site : Cowey Island, NY *
 * RV summary : AS 17 *
 * _____ *
 * _____ *

AV Black & White covers on a

SG1J

2 Aug 85
Ft. Meade, MD
20755

SG1J

09:33

951601
975930

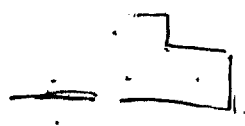

A. nose
flat
hard

B. land

A. nose
angle
drag
solid

B. structure

A. drag angle nose
angle drag
solid

B. structure

S-2
Pond shell
brown
swirling

compression break

951601
975930



A. cross
ways
fluid
B. water

A. Curving around
miss break

951601
975930



A. along ^{curving}
around
compression break

951601
975930



A.
Compression break

951601
975930



A. cross
heavy
semi solid
B. Sand

Site is land/water interface w/ structures present and a sandy area.

951601
975930

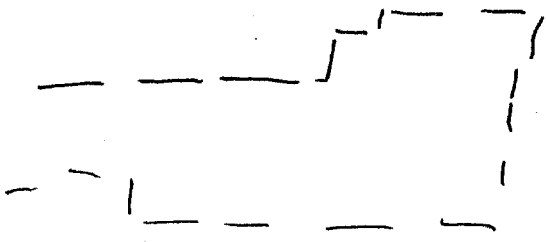

A.
Corrosion break

951606
975930

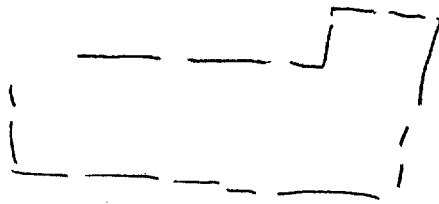

A. around
angle
Space
Solid
unusual

B. "

S-2
green
tan
white
blue
herby smell

AOL BK
like a feed lot

AOL BK
Fence or enclosure

951601
975930



A. spaced
angle
regular
also
Solid +
not solid

B. structure

S-2
red
rough
vab b, y sound
smells pleasant

AJ BK
feel very relaxed

951601

975930

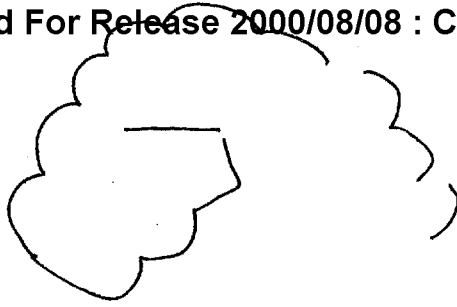

A.
Confusion, break

951601

975930

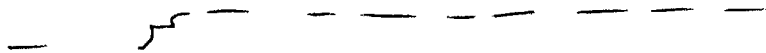

A. above
along
space
hard
manually

B. —

S-2
brown
steel blue
red
soft
warm
smooth
green
condensation

A2 Break
just small

red
squeak
up/down

rounded
flat
dim
white
regularly spaced
long/short, long/short
running along
low
extending

A2 Break

green
salty taste
wet
blue
curving
smooth
cool
clean smell
round
cylindrical
dk colored
long
thin
round

AsL B6
thick metal wire

AsL Break
Suspension
bridge w/ sparkly
water underneath

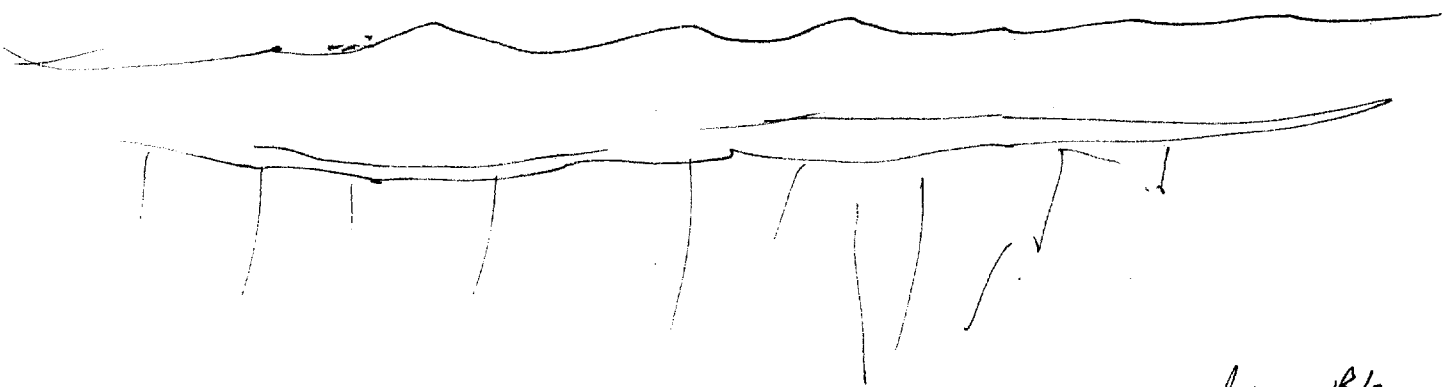
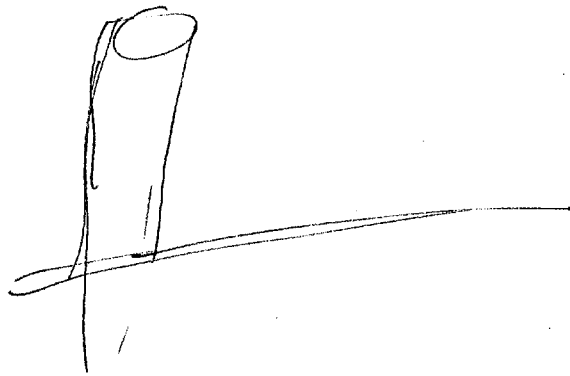

AsL B6
Large beach
w/ numerous stones
people &
colored umbrellas

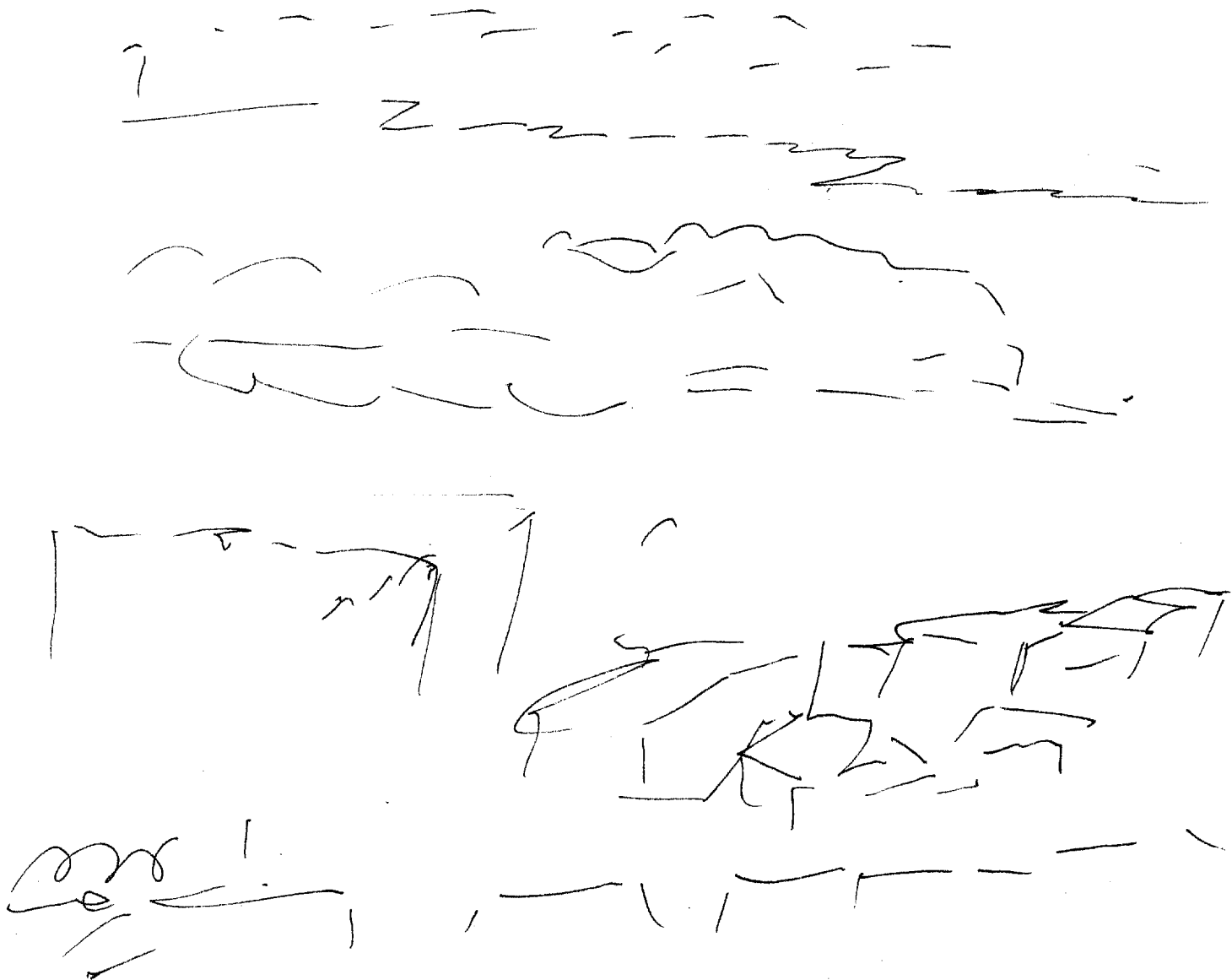

S.2

~~Approved For Release 2000/08/08 : CIA-RDP96-00789R001700120001-0~~

8

Approved For Release 2000/08/08 : CIA-RDP96-00789R001700120001-0

S-2
green
white

D

AZ

FI

T

J

AZ

VA/S

Stripes

black
warm
soft
rainy

warm
sand

AZ BK
felt good

sea bird
sounds

black
white

flat
bumpy

AZ
feel
wavy

food
smells

sweet
smells

sunny

Structure

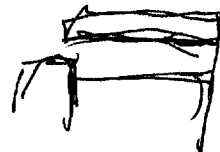

S-2

D

AZ

IEI

T I

ADL

A/S

warm
comfortable
feel

AZ BK
relaxing

wide
expansive

bright
buzzy

sand

red
white

people
not wearing
much
warm skin

people
laughing
unworried

Black

foamy
water

S-2

D AZ EI T I AOL ALS

Play

AOL BK
surfing

dog

AOL BK
playing
fr. 2 ball

Yellow

recreation
instruction

swimming

Bermuda

Bermuda

22we

boats

AOL BK
pleasant

segregates
divided off
relaxing

S-2
Shady

D

AZ

EI

T

I

Adc

Als

tumbrells

gently
slipping

Adc Bk
Nudist
beach

AZ
Soviet
Blacksea
Nudist beach

S-2 D AI EI T I AOL ALS
Structure

Yellow
rectangular
relatively
low

Green

for 1316
wh 4.143
Bross gas stacks

black

break

round
sections
domed

grey

large

roof

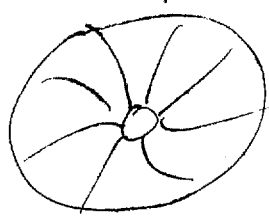

Green

large
hills etc
vaulted

for bk
like a huge

S-2

D

AI

EI

T

I

Asl

A/S

vibbed

inside

industrial
assembly

mechanical
sounds

acid
smell

cool

flashes
inside



Asl Bk
space shuttle
Cape Canaveral

AI Bk
chills

purple
uniform
mound

Sightseeing
contemplating
Secret. history

boom-out

history

Asl Bk
Kitty hawk

S-2 D A2 EI T I A02 ALS

outside

Bright
Sunny
warm

buildings

large
structure

red
sign

metal
flat hard
concrete
aprons

AOL BIC
airfield

AOL BIC
Freds Florida
property

Sculpture

peaceful
designed
aesthetically
organized

bls

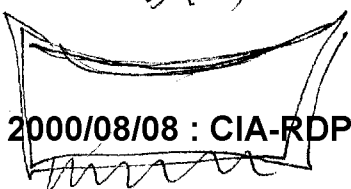

S2

D

A1 ~~FI~~

T

I

ADL

HS

outside

Ad BC
University

Ad BT
Amusement
Park
"Disney world"

lattice-like
structure

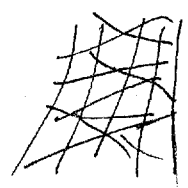

partico

Interior Summary

Site is a structure/land/sand/water interface, highly suggestive of a recreational beach-type area. Some important structures are located "behind" the beach-like area. One structure is large, empty and possibly domed, reminiscent of an airplane hangar. ~~Some~~ Colorful, beautiful, that people are present at the beach-like area; others are walking, perhaps sightseeing in the large building. The area with the bldgs is well kept, & engineered for an open, aesthetic ~~feature~~ inspection. Primary purpose of site is varied types of recreation. A sense of "segregation" or "dividing up" is present, involving such things as people, groups, skill levels, etc. Sightseeing is also important.

Site end

11:39

Segregated
objects
emanations?
ropes
lines
poles
areas
lifeguards

Segregated
attributes
emanations?
categories
classes

Segregated
subjects
emanations?
people
groups
places
areas
still levels
danger zone
private areas

Segregated
topics
emanations?
crowds
organizations
control
protection
safety

play
objects
emanations ?
ball
net
water

play
attributes
emanations ?
loud
wild
scattered
relaxed

Play
Subjects
emanations ?
game
recreation
relaxation
competitions
supervision
maintenance
diversion

play
topics
emanations ?

Sight seeing
objects
emanations?
airplanes
displays
people
buildings
landscape
location
shops

Sight seeing
attributes
emanations?
organized
collected
displayed
protected
decorated
designed

Sight seeing
Subjects
emanations?

technology
future
past
present

human beings
biology
main life
space kosmos
crafts people
restaurants
kitchen stores

Sightseeing
topics
monuments?
people
good
items

Coney Island

Facing the Atlantic, Coney Island has a fine beach and boardwalk. Over the last few years it has become a place of high rise apartment buildings. Scattered among these highrises are 1-2 family homes of some 100,000 persons of diverse ethnic and native origin. This housing ranges from slum to middle class.

Besides beach and boardwalk, many carnival amusement features on Surf Avenues draw a host of visitors, especially on Summer weekends. The NY Aquarium, with about 7,000 specimens of marine life is located on the ocean front.